

# STRUCTURA

by BESTILE

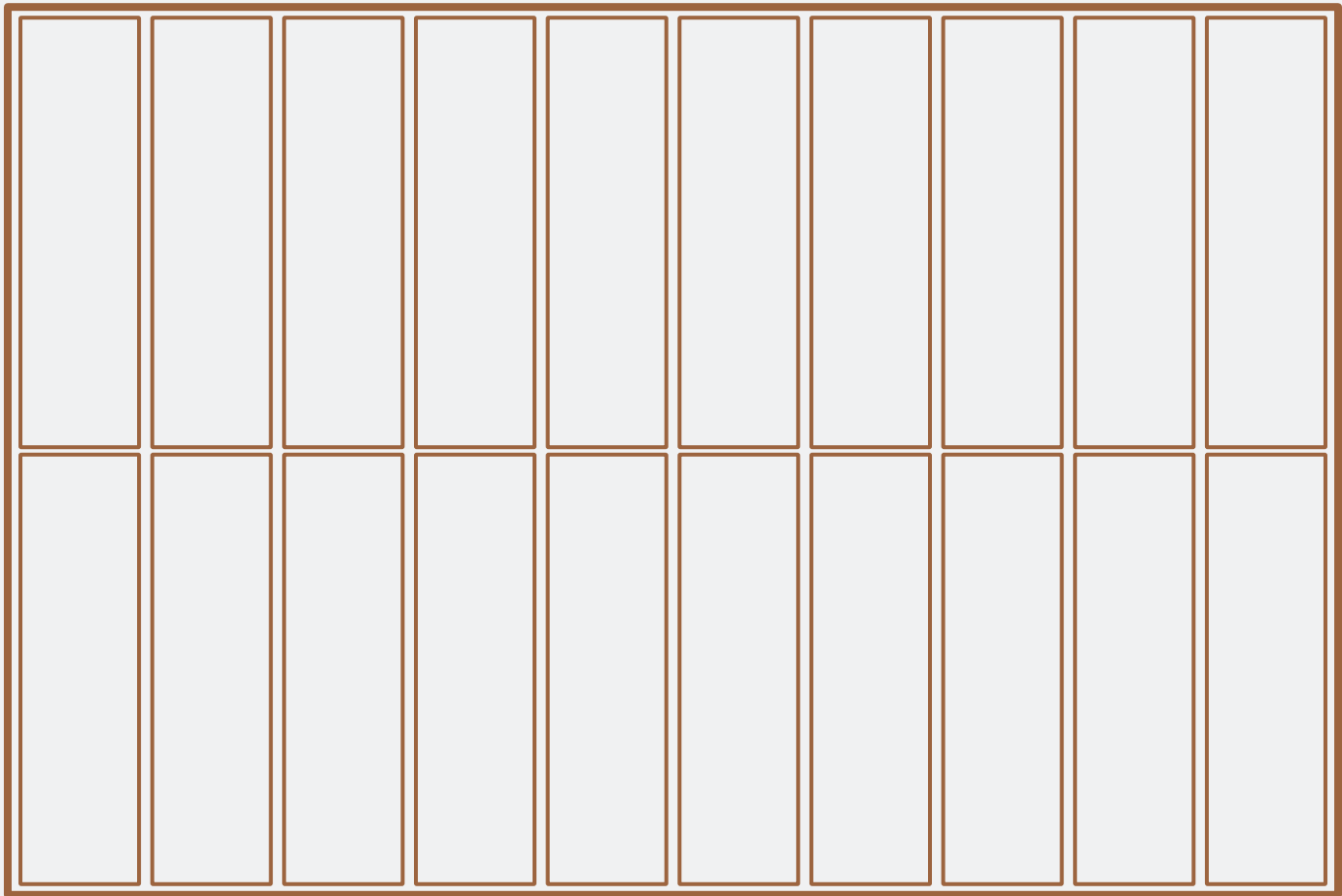

## NAOS

GLAZED PORCELAIN TILES

40x60x1,2 cm

15,7"x23,6"x0,5"

*Engineered for Design. Built for Impact.*

# NAOS

GLAZED PORCELAIN TILES

structura  
by BESTILE

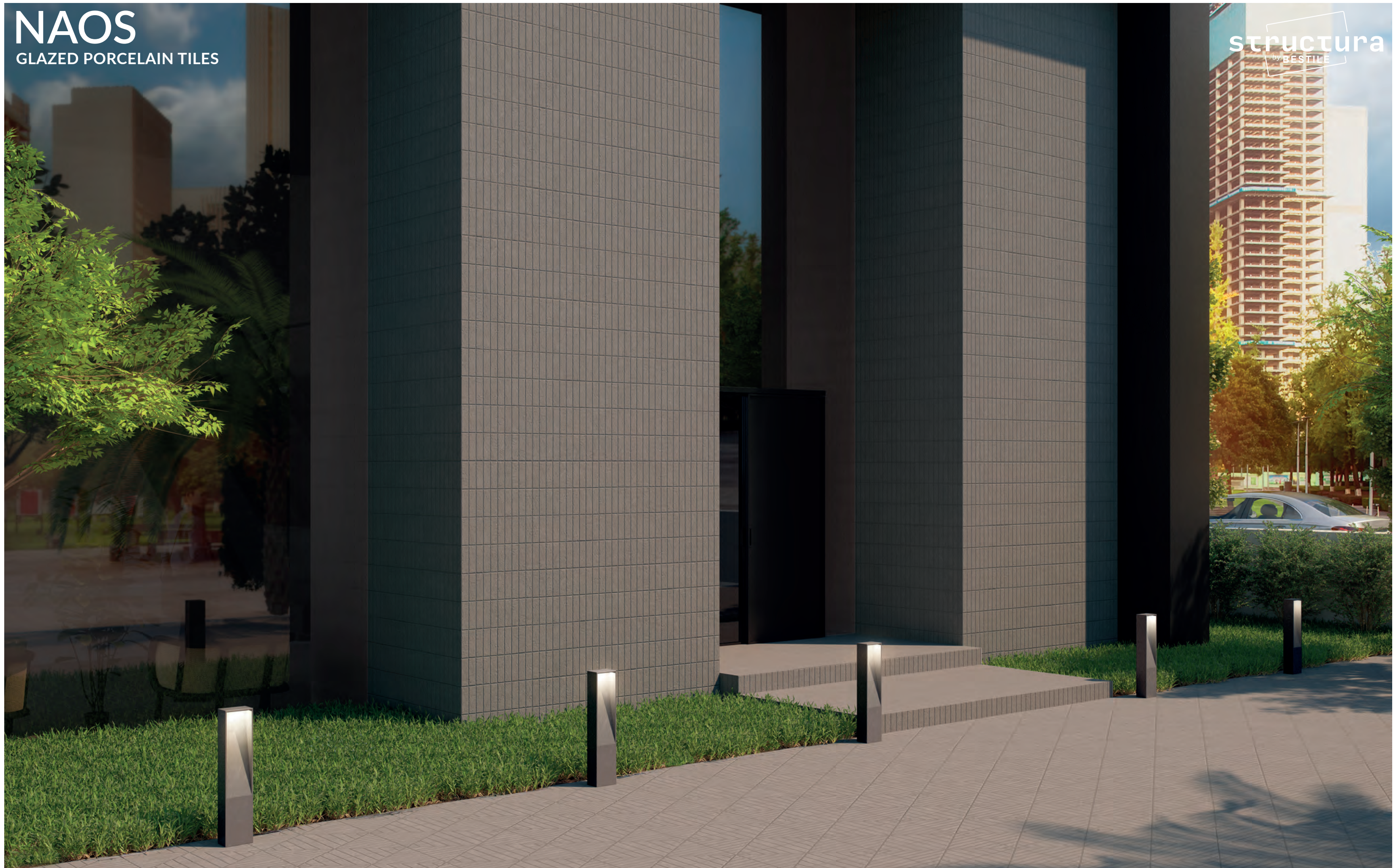

NAOS  
GLAZED PORCELAIN TILES

structura  
by BESTILE



# NAOS

GLAZED PORCELAIN TILES

structura  
by BESTILE



NAOS  
GLAZED PORCELAIN TILES

structura  
by BESTILE



# NAOS

GLAZED PORCELAIN TILES

structura  
by BESTILE



Different graphics randomly packaged

Naos  
Glazed Porcelain Tiles  
40x60x1,2 cm  
15,7"x23,6"x0,5"



Naos Beige



Naos Gris



Naos Taupe



Naos Noir



**Recommended joint width: 1.5 mm.**  
For optimal adhesion, prepare the grout by mixing 50% clean water and 50% latex additive.  
**Junta recomendada: 1,5 mm.**  
Para una adherencia óptima, preparar el material de rejuntado mezclando 50% de agua limpia y 50% de aditivo de látex.

Size		Model	Pz Bx	Sqm Bx	Kg Box	Bx Pallet	Sqm Pallet	Kg Pallet
40x60x1,2 cm 15,7"x23,6"x0,5"	GPR	Naos	5 pz	1,20	29,87	40 bx	48,00	1.209

**BESTILE**  
*Time to Create*

Pda. Torreta S/N \_ 12110 - Alcora\_Castellón (ESPAÑA) \_ +34 964 367 320

[www.bestile.es](http://www.bestile.es)